

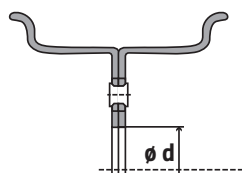

Split Rim



Ring rim

(negative offset)

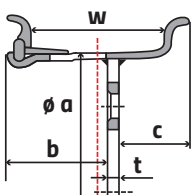

Ring rim

(positive offset)

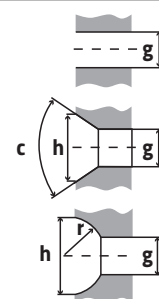
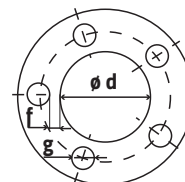
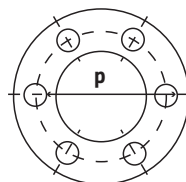
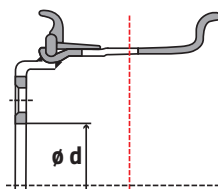

| | RIM SIZE | CENTRAL BORE | ϕ PITCH CIRCLE | NUMBER | ϕ HOLE | ϕ CHAMFER | CHAMFER | OFFSET | RINGSET | PART# |
|-----|-----------|--------------|---------------------|----------|-------------|----------------|----------|--------|----------|----------|
| | w - a | d (MM) | p (MM) | OF HOLES | g (MM) | h (MM) | TYPE c/r | b (MM) | OPTIONAL | |
| 8" | 3.00 - 8 | 80 | 115 | 5 | 14,5 | 19,0 | C60 | - | - | 03870800 |
| | | 94 | 140 | 5 | 18,5 | 24,0 | R14 | - | - | 03870802 |
| | | 100 | 125 | 6 | 16,0 | 19,0 | C60 | - | - | 03870804 |
| | | 110 | 148 | 6 | 14,5 | 17,5 | C60 | - | - | 03870806 |
| | 3.75I - 8 | 85,7 | 114,3 | 5 | 14,5 | 17,5 | C60 | - | - | 03870808 |
| | 4.33R - 8 | 94 | 140 | 5 | 18,5 | 24,0 | R14 | - | - | 03870810 |
| | | 100 | 139 | 6 | 18 | 20 | - | - | - | 03870812 |
| | | 110 | 150 | 5 | 17 | 21 | - | - | - | 03870811 |
| 9" | 4.00 - 9 | 125 | 170 | 5 | 17 | 19 | - | - | - | 03870901 |
| | | 130 | 160 | 8 | 16,0 | 20,0 | C60 | - | - | 03870900 |
| | | 140 | 170 | 6 | 16,0 | 21,0 | C60 | - | - | 03870902 |
| | | 142 | 170 | 8 | 17,5 | 20,8 | C60 | - | - | 03870904 |
| | | 150 | 180 | 6 | 17,5 | 21,0 | C60 | - | - | 03870906 |
| 10" | 5.00 - 10 | 130 | 160 | 8 | 16,0 | 20,0 | C60 | - | - | 03871000 |
| | | 140 | 170 | 6 | 16,0 | 20,0 | C60 | - | - | 03871002 |
| | | 142 | 170 | 8 | 17,5 | 20,8 | C60 | - | - | 03871004 |
| | | 150 | 180 | 6 | 17,5 | 21,0 | C60 | - | - | 03871006 |
| 12" | 5.00 - 12 | 144 | 190 | 8 | 27,0 | 32,0 | C80 | - | - | 03871200 |
| | | 150 | 200 | 6 | 27,0 | 31,5 | C60 | - | - | 03871202 |
| | | 170 | 220 | 6 | 27,0 | 31,5 | C60 | - | - | 03871204 |
| | | 170 | 220 | 6 | 32,0 | 37,0 | R22 | - | - | 03871206 |
| | | 175 | 220 | 5 | 27,0 | 31,5 | C60 | - | - | 03871208 |

RIMS COMPLETE WITH BOLTS, NUTS AND WASHERS.



Split Rim

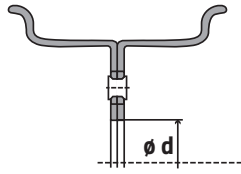

Ring rim

(negative offset)

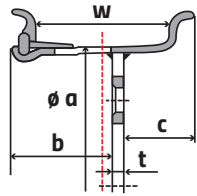

Ring rim

(positive offset)

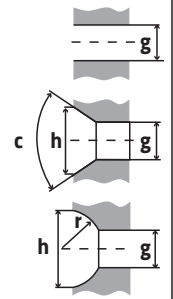
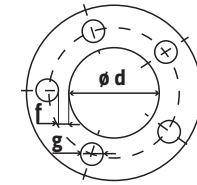
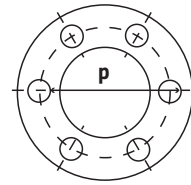
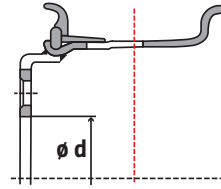

| RIM SIZE | CENTRAL BORE | ϕ PITCH CIRCLE | NUMBER | ϕ HOLE | ϕ CHAMFER | CHAMFER | OFFSET | RINGSET | PART# | |
|----------|--------------|---------------------|----------|-------------|----------------|----------|----------|----------|----------|----------|
| w - a | d (MM) | p (MM) | OF HOLES | g (MM) | h (MM) | TYPE c/r | b (MM) | OPTIONAL | | |
| 8" | 3.00D-8 | 80 | 120 | 5 | 18,5 | 23 | - | 22 | 67514939 | 03890807 |
| | | 102 | 135 | 5 | 18 | 21 | - | 1 | - | 03890813 |
| | | 110 | 145 | 5 | 18,5 | 24 | R14 | -25,4 | 67514932 | 03890806 |
| | | 110 | 145 | 5 | 18,5 | 24 | R14 | -5 | 67514932 | 03890808 |
| | | 110 | 145 | 5 | 18,5 | 24 | 2R14 | -2 | 67514932 | 03890810 |
| | | 110 | 145 | 5 | 18,5 | 24 | R14 | 0 | 67514932 | 03890812 |
| | | 110 | 145 | 5 | 18,5 | 24 | R14 | 35 | 67514932 | 03890814 |
| | | 110 | 145 | 5 | 19 | 24 | - | -12,5 | - | 03890815 |
| | | 110 | 145 | 5 | 20 | 24 | - | 2 | - | 03890819 |
| | | 110 | 148 | 6 | 14,5 | 18 | C60 | -4,5 | 67514932 | 03890816 |
| | 4,33R-8 | 85 | 130 | 6 | 18,5 | 24 | R14 | -17 | 67514939 | 03890820 |
| | | 86 | 130 | 6 | 19 | 27 | - | -31 | - | 03890837 |
| | | 90 | 130 | 5 | 18 | 20 | - | 48 | - | 03890831 |
| | | 90 | 130 | 6 | 17,5 | 20,8 | C60 | 11 | 67514939 | 03890822 |
| | | 94 | 130 | 8 | 17 | 17 | - | 20 | - | 03890823 |
| | | 100 | 125 | 6 | 16 | 19,8 | C60 | -19 | 67514939 | 03890824 |
| | | 100 | 135 | 6 | 17,5 | 20,8 | C60 | 0 | 67514939 | 03890826 |
| | | 100 | 135 | 6 | 17 | 21 | C60 | 41 | 67514939 | 03890828 |
| | | 101 | 135 | 5 | 14 | 20 | R12 | -7 | 67514939 | 03890830 |
| | | 101 | 140 | 6 | 20 | 28 | R16 | -5 | 67514939 | 03890832 |
| | | 106 | 140 | 10 | 20 | 24 | - | -4 | - | 03890835 |
| | | 108 | 135 | 8 | 15 | 20 | - | 32 | - | 03890821 |
| | | 110 | 140 | 5 | 18 | 24 | - | -1 | - | 03890855 |
| | | 110 | 145 | 5 | 18 | 24 | - | -28 | - | 03890833 |
| | | 110 | 145 | 5 | 18 | 24 | - | 30 | 67514932 | 03890851 |
| 110 | | 145 | 5 | 18 | 24 | - | 39 | - | 03890839 | |
| 110 | | 145 | 5 | 18,5 | 24 | 2R14 | -35 | 67514939 | 03890834 | |
| 110 | | 145 | 5 | 18,5 | 24 | 2R14 | 25 | 67514939 | 03890844 | |
| 110 | | 145 | 5 | 18,5 | 24 | R14 | 40 | 67514939 | 03890848 | |
| 110 | | 145 | 5 | 19 | 23 | - | 34 | - | 03890841 | |
| 110 | 145 | 6 | 18 | 22 | C | 8 | 67514939 | 03890853 | | |
| 110 | 145 | 7 | 18,5 | 24 | - | 35 | - | 03890845 | | |
| 110 | 145 | 7 | 19 | 25 | - | 42 | - | 03890852 | | |
| 110 | 150 | 5 | 19 | 25 | - | 0 | 67514939 | 03890849 | | |
| 110 | 150 | 5 | 22 | 27 | - | 3 | - | 03890843 | | |
| 9" | 4.00E-9 | 103 | 140 | 5 | 17,5 | 21 | - | -4 | - | 03890903 |
| | | 110 | 139 | 6 | 13,5 | - | - | -4,5 | 67514959 | 03890902 |
| | | 110 | 140 | 5 | 20 | 24 | - | -4,5 | - | 03890904 |
| | | 110 | 150 | 5 | 20 | 24 | - | -4 | - | 03890907 |
| | | 110 | 160 | 5 | 18,5 | 24 | R14 | -6 | 67514959 | 03890904 |
| | | 123,9 | 165,1 | 5 | 16 | 22 | C90 | -11,5 | 67514959 | 03890908 |
| | | 124 | 164 | 5 | 16 | 22 | - | -5 | - | 03890909 |
| | | 130 | 160 | 8 | 16 | 20 | C60 | -5 | 67514959 | 03890910 |
| | | 140 | 170 | 6 | 18 | 21 | C60 | -4,5 | 67514959 | 03890912 |



Split Rim

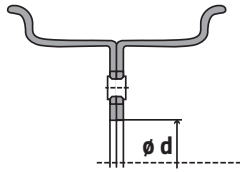

Ring rim

(negative offset)

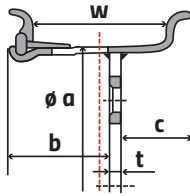

Ring rim

(positive offset)

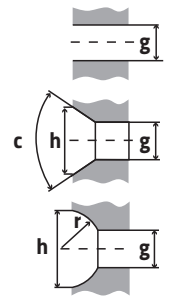
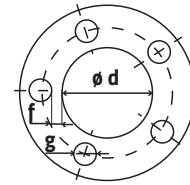
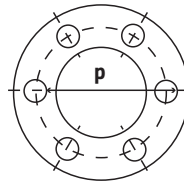
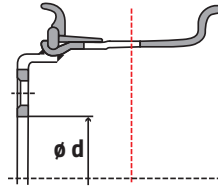

| RIM SIZE | CENTRAL BORE | ϕ PITCH CIRCLE | NUMBER | ϕ HOLE | ϕ CHAMFER | CHAMFER | OFFSET | RINGSET | PART# | |
|----------|--------------|---------------------|----------|-------------|----------------|----------|----------|----------|----------|----------|
| w - a | d (MM) | p (MM) | OF HOLES | g (MM) | h (MM) | TYPE c/r | b (MM) | OPTIONAL | | |
| 9" | 4.00E-9 | 150 | 6 | 17,5 | 20,8 | C60 | -5 | 67514959 | 03890914 | |
| | 6.00E-9 | 102 | 142 | 6 | 28 | 33 | - | 35 | - | 03890927 |
| | | 110 | 145 | 5 | 18 | 24 | - | 5 | - | 03890929 |
| | 110 | 145 | 5 | 19 | 24 | - | 4 | - | 03890925 | |
| | 110 | 160 | 5 | 18,5 | 24 | 2R14 | 24 | 67514959 | 03890924 | |
| | 110 | 160 | 5 | 18,5 | 24 | 2R14 | 74 | 67514959 | 03890926 | |
| | 123,5 | 156 | 6 | 18,5 | 24 | R14 | -28 | 67514959 | 03890928 | |
| | 130 | 160 | 8 | 17,5 | 20,8 | C60 | -16 | 67514959 | 03890930 | |
| 10" | 5.00F-10 | 110 | 160 | 5 | 18,5 | 24 | R14 | 0 | 67514979 | 03891006 |
| | | 127 | 165,1 | 5 | 15,5 | 22,2 | C90 | -5 | 67514979 | 03891008 |
| | | 140 | 170 | 6 | 18 | 21 | C60 | -5 | 67514979 | 03891012 |
| | | 150 | 180 | 6 | 17,5 | 20,8 | C60 | -6 | 67514979 | 03891016 |
| | | 150 | 180 | 6 | 17 | 21 | - | 0 | 67514979 | 03891017 |
| | 6.50F-10 | 85 | 130 | 6 | 18,5 | 24 | R14 | -10 | 67514979 | 03891020 |
| | | 110 | 145 | 5 | 18,5 | 24 | 2R14 | -25 | 67514979 | 03891024 |
| | | 110 | 145 | 5 | 18,5 | 24 | R14 | 7,5 | 67514979 | 03891026 |
| | | 110 | 145 | 5 | 18,5 | 24 | R14 | 25 | 67514979 | 03891028 |
| | | 110 | 145 | 7 | 18,5 | 24 | R14 | -5 | 67514979 | 03891030 |
| | | 110 | 150 | 5 | 18 | 24 | - | 4 | - | 03891029 |
| | | 110 | 150 | 5 | 18 | 24 | - | 5 | - | 03891021 |
| | | 110 | 150 | 7 | 18 | 24 | - | 31 | - | 03891027 |
| | | 110 | 160 | 5 | 22 | 27 | R16 | 49 | 67514979 | 03891031 |
| | | 112 | 150 | 5 | 19 | 23 | - | 16 | - | 03891033 |
| | | 135 | 170 | 6 | 21,5 | 27 | R16 | 4 | 67514979 | 03891034 |
| | | 139 | 170 | 10 | 18,5 | 24 | R14 | 4 | 67514979 | 03891036 |
| | | 140 | 170 | 10 | 20 | 24 | - | 53,5 | - | 03891035 |
| | | 145 | 178 | 10 | 18,5 | 24 | R14 | 10 | 67514979 | 03891038 |
| | | 145 | 180 | 11 | 17 | 22 | - | 11 | - | 03891037 |
| 145 | 180 | 14 | 16 | - | - | 76 | - | 03891023 | | |
| 150 | 180 | 8 | 17,5 | 20,8 | C60 | -17,5 | 67514979 | 03891040 | | |
| 150 | 180 | 8 | 18 | 24 | - | 5 | - | 03891025 | | |
| 12" | 5.00S-12 | 144 | 190 | 8 | 27 | 32 | C80 | -6 | 67514998 | 03891200 |
| | | 150 | 200 | 6 | 27 | 31,5 | C60 | -6 | 67514998 | 03891202 |
| | | 152 | 204 | 5 | 26 | - | - | -8 | 67514998 | 03891204 |
| | | 161 | 205 | 6 | 21,5 | 27 | R16 | 0 | 67514998 | 03891206 |
| | | 161 | 205 | 6 | 21,5 | 27 | R16 | 30 | 67514998 | 03891208 |
| | | 161 | 205 | 6 | 21,5 | 27 | R16 | 102 | 67514998 | 03891210 |
| | | 165,7 | 218 | 6 | 32,5 | 39,5 | R22 | -6 | 67514998 | 03891212 |
| | 166 | 218 | 6 | 35 | 39 | - | 0 | - | 03891201 | |
| | 170 | 220 | 6 | 32,5 | 39,5 | R22 | -6 | 67514998 | 03891214 | |
| | 8.00G-12 | 93 | 140 | 10 | 15 | - | - | 30 | 67514998 | 03891218 |
| | | 110 | 160 | 5 | 21,5 | 27 | R16 | 40 | 67514998 | 03891220 |
| | | 145 | 178 | 10 | 18,5 | 24 | R14 | -5 | 67514998 | 03891228 |



Split Rim

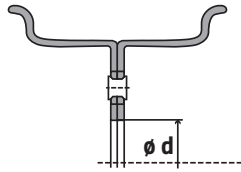

Ring rim

(negative offset)

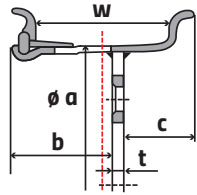

Ring rim

(positive offset)

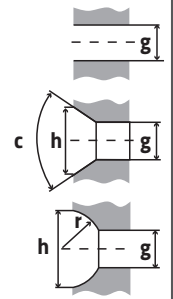
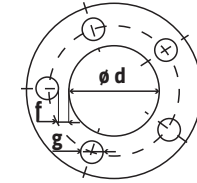
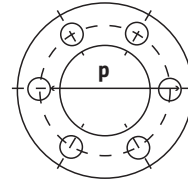
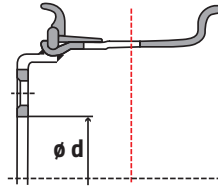

| | RIM SIZE w - a | CENTRAL BORE d (MM) | Ø PITCH CIRCLE p (MM) | NUMBER OF HOLES | Ø HOLE g (MM) | Ø CHAMFER h (MM) | CHAMFER TYPE c/r | OFFSET b (MM) | RINGSET OPTIONAL | PART# |
|---------|-------------------|------------------------|--------------------------|--------------------|------------------|---------------------|---------------------|------------------|---------------------|----------|
| 12" | 8.00G-12 | 145 | 180 | 14 | 16 | - | - | 80 | 67514998 | 03891229 |
| | | 161 | 205 | 6 | 21,5 | 27 | R16 | -15 | 67514998 | 03891230 |
| | | 161 | 205 | 6 | 21 | 27 | - | -10 | 67514998 | 03891244 |
| | | 161 | 205 | 6 | 21,5 | 27 | 2R16 | 0 | 67514998 | 03891232 |
| | | 161 | 205 | 6 | 21,5 | 27 | R16 | 30 | 67514998 | 03891234 |
| | | 165,7 | 218 | 6 | 32,5 | 37 | R22 | -45 | 67514998 | 03891238 |
| | | 170 | 218 | 6 | 16 | 22 | C90 | -80 | 67514998 | 03891240 |
| | | 171 | 220 | 6 | 32 | 37 | C60 | -40 | 67514998 | 03891242 |
| 15" | 6.5-15 | 176 | 225 | 10 | 27 | 32 | R18 | 70 | 67515012 | 03891507 |
| | | 176 | 225 | 10 | 27 | 32 | R18 | 124 | 67515012 | 03891508 |
| | | 176 | 225 | 10 | 27 | 32 | 2R18 | 124 | 67515012 | 03891509 |
| | | 221 | 275 | 8 | 27 | 32 | 2R18 | -26 | 67515012 | 03891512 |
| | | 221 | 275 | 8 | 27 | 32 | 2R18 | 36 | 67515012 | 03891513 |
| | | 221 | 275 | 8 | 27 | 32 | 2R18 | 124 | 67515012 | 03891514 |
| | | 230 | 283 | 12 | 27 | 32 | R18 | 38 | 67515012 | 03891515 |
| | | 230 | 283 | 12 | 27 | 32 | R18 | 129 | 67515012 | 03891516 |
| | | 240 | 290 | 6 | 32,5 | 37 | 2R22 | 134 | 67515012 | 03891518 |
| | 7.0-15 | 164 | 222,25 | 6 | 32,5 | 37 | R22 | 40 | 67515026 | 03891521 |
| | | 165 | 222 | 6 | 33 | 36 | - | 42 | - | 03891572 |
| | | 165,7 | 218 | 6 | 32,5 | 37 | R22 | -75 | 67515026 | 03891522 |
| | | 165,7 | 218 | 6 | 32,5 | 37 | R22 | -7 | 67515026 | 03891523 |
| | | 170 | 220 | 6 | 32,5 | 37 | R22 | -6 | 67515026 | 03891524 |
| | | 170 | 220 | 6 | 32 | 37 | - | 56 | 67515026 | 03891566 |
| | | 170 | 320 | 6 | 25 | - | - | -6 | - | 03891571 |
| | | 176 | 225 | 10 | 27 | 32 | R18 | -15 | 67515026 | 03891525 |
| | | 176 | 225 | 10 | 27 | 32 | R18 | 20 | 67515026 | 03891526 |
| | | 176 | 225 | 10 | 27 | 32 | R18 | 55 | 67515026 | 03891527 |
| | | 176 | 225 | 10 | 27 | 32 | 2R18 | 75 | 67515026 | 03891528 |
| | 178 | 210 | 14 | 16 | - | - | 68 | 67515026 | 03891529 | |
| 8.0-15 | 176 | 225 | 10 | 27 | 32 | R18 | -216 | 67515046 | 03891541 | |
| | 176 | 225 | 10 | 27 | 32 | 2R18 | 95 | 67515046 | 03891542 | |
| | 200 | 245 | 10 | 20 | - | - | 97 | 67515026 | 03891565 | |
| | 200 | 260 | 6 | 32,5 | 37,5 | R22 | 56,5 | 67515046 | 03891544 | |
| | 221 | 275 | 8 | 27 | 32 | 2R18 | -40 | 67515046 | 03891545 | |
| | 221 | 275 | 8 | 27 | 32 | R18 | 55 | 67515046 | 03891546 | |
| | 230 | 283 | 12 | 27 | 32 | R18 | 63 | 67515046 | 03891547 | |
| 9.75-15 | 176 | 225 | 10 | 27 | 32 | R18 | 0 | 67515026 | 03891554 | |
| | 176 | 225 | 10 | 27 | 32 | 2R18 | 20 | 67515026 | 03891555 | |
| | 221 | 275 | 8 | 27 | 32 | 2R18 | -33 | 67515026 | 03891556 | |
| | 221 | 275 | 8 | 27 | 32 | 2R18 | -13 | 67515026 | 3891557 | |
| | 221 | 275 | 8 | 27 | 32 | R18 | 12 | 67515026 | 03891558 | |
| | 221 | 275 | 8 | 27 | 32 | R18 | 40 | 67515026 | 03891559 | |
| | 221 | 275 | 8 | 27 | 32 | R18 | 75 | 67515026 | 03891560 | |
| | 230 | 283 | 12 | 27 | 32 | R18 | 63 | 67515026 | 03891561 | |

Wheel Spec Sheet

If available, please provide information to A, B & C

A. OEM Part # _____

B. Wheel Manufacturer's Part No. _____

C. Tire Size: _____

Information Taken By: _____

Verified by: _____

Date: _____

Customer Company: _____

Contact Name: _____

Equipment Make: _____

Equipment Model: _____

No. of Pieces Per Wheel (Check One)

- 1 Piece Wheel
- 2 Piece Wheel
- 3 Piece Wheel
- 4 Piece Wheel
- 5 Piece Wheel

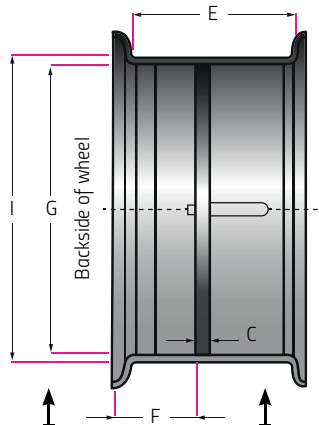

CHECK SIDE OF WHEEL THAT FACES MACHINE

WHEEL DIMENSIONS:

- C. Disc Thickness _____
- E. Wheel Width _____
- F. Disc Offset from Machine _____
- Side of Wheel _____
- G. ID of Rim at Plate _____
- Location _____
- I. Wheel Diameter _____

WHEEL REQUIREMENTS:

CHECK ONE:

Lock-in:

Lock Out:

D. Paint Color: _____

E. Paint Code: _____

BOLT REQUIREMENTS

Number of bolts per wheel: _____

EVEN NUMBER OF BOLTS

For EVEN # of BOLT HOLES (eg. 6, 8, 10, 12...)

Bolt hole Circle (B) _____

Bolt hole Diameter (C) _____

Pilot hole Diameter (A) _____

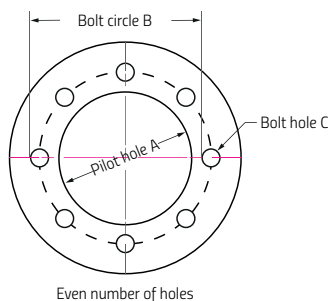

Even number of holes

ODD NUMBER OF BOLTS:

For ODD # of BOLT HOLES (eg. 5, 7, 9, 11...)

Bolt hole Circle (B1 + B2) _____

Bolt hole Diameter (C) _____

Pilot hole Diameter (A) _____

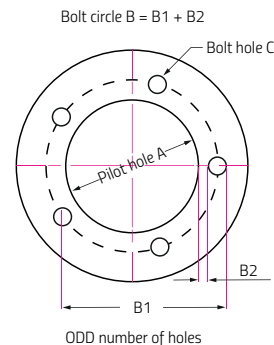

ODD number of holes

INTELLA LIFTPARTS supplies wheels as per specifications supplied by the customer and is not liable for any issues related to wheel design and engineering including, but not limited to, issues such as fitment, load capacity and or suitability of use on a particular piece of equipment. Wheels supplied by Intella Liftparts are for off road applications only.

PLEASE SCAN/EMAIL COMPLETED FORM TO SALES@INTELLALIFTPARTS.COM FOR A QUOTATION. FAX 616-796-2096